

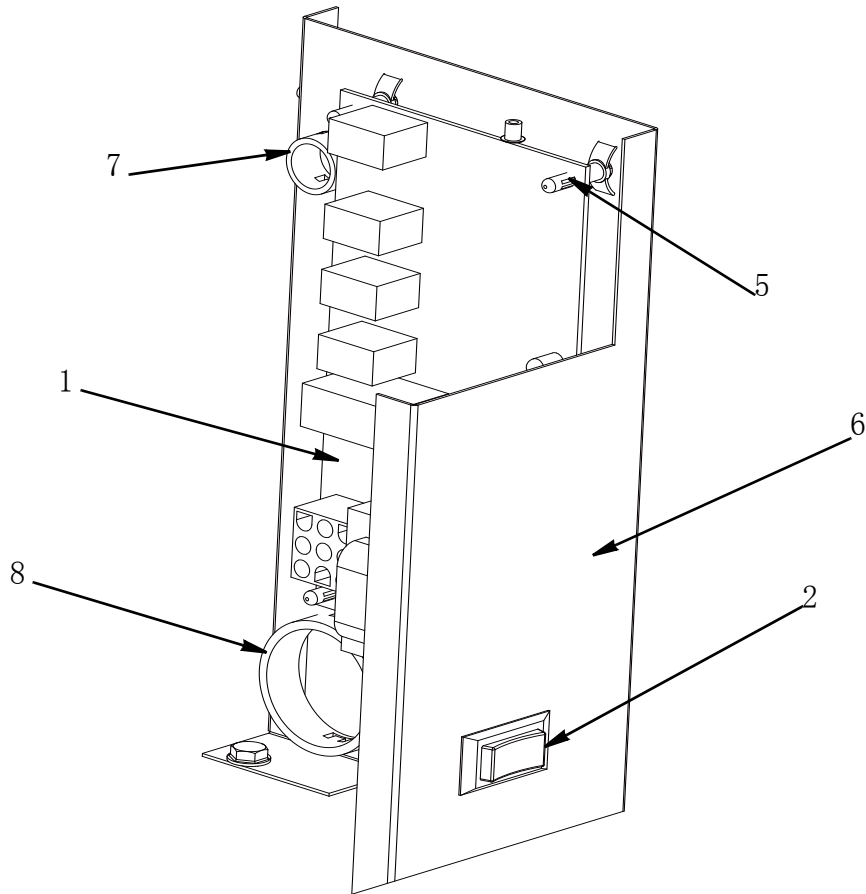

**Ice Machine Parts List for  
Series ES90 Models**

**ES90A**

## ES90 CONTROL BOX



### DESCRIPTION

	<b>PART NO.</b>
1 Control Board- 230V 60Hz .....	040003380
2 Control Board- 230V 50Hz .....	040002301
3 <b>Toggle Switch</b> Only .....	2301513
4 <b>Wiring Harness</b>	
a. Wiring Harness- Switch (Not shown) .....	040002591
5 <b>Power Cord</b>	
a. 230V 50Hz (Not shown) .....	040002495
b. 230V 60Hz (Not shown) .....	2006873

### Miscellaneous – Brackets, Screws, etc.

6 Control Board Mounting Supports .....	4302253
7 Control Box .....	040002659
8 Bushing .....	2502183
9 Bushing .....	2500133

## ES90 EVAPORATOR ASSEMBLY

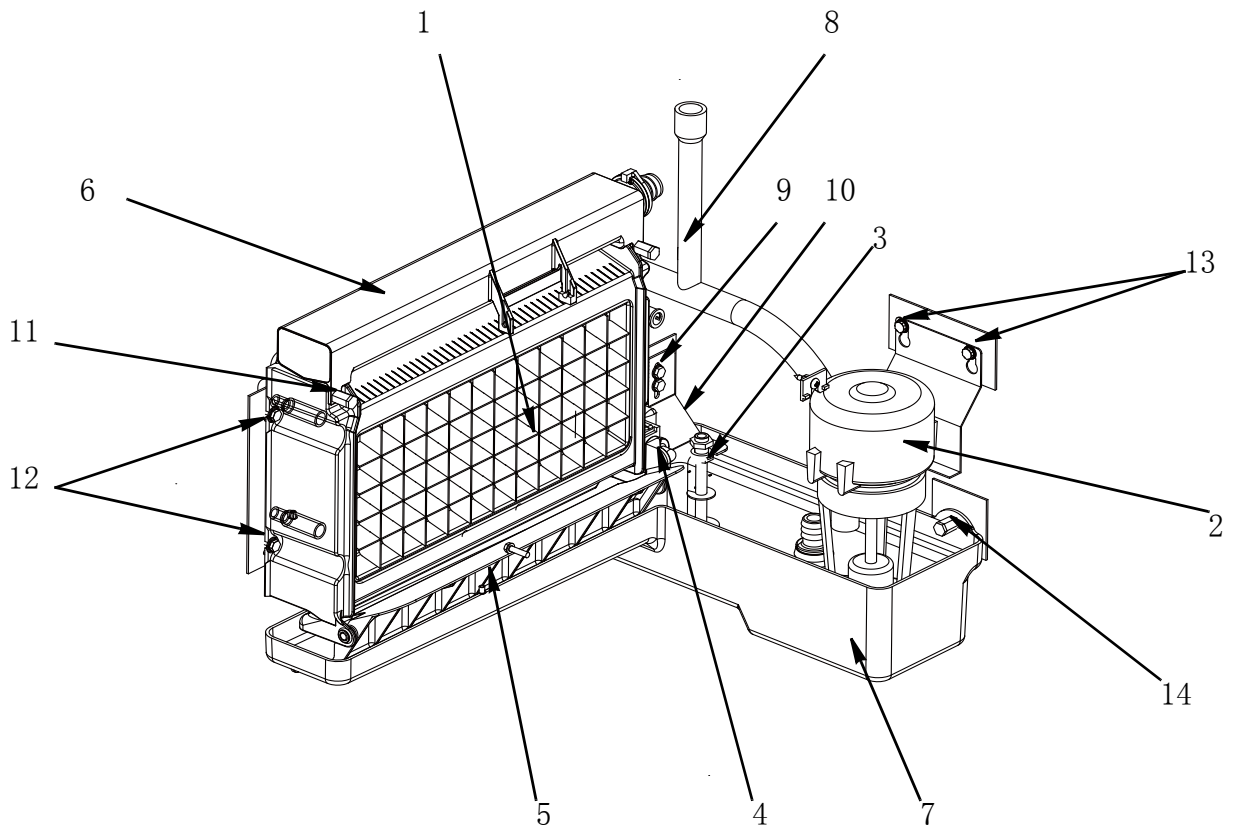

### DESCRIPTION

### PART NO.

1	<b>Evaporator Assembly</b>	
a.	Dice Cube . . . . .	040003682
2	<b>Water Pump</b>	
a.	230V/60 Hz . . . . .	
b.	230V/50 Hz(before 310145261) . . . . .	040002504
3	Water Level Probe . . . . .	040002827
4	Magnetic Bin Switch (Mounted to Evaporator). . . . .	040002481
5	Ice Damper. . . . .	7600493
a.	Ice Damper Magnet and Cap . . . . .	7629093
6	Water Distribution Tube . . . . .	000007163
7	Water Trough . . . . .	040002513
8	Tubing (Water Pump Out) . . . . .	040003270
<b>Miscellaneous – Brackets, Screws, etc.</b>		
9	Screw, #10-24 x .50 . . . . .	000003162
10	Bracket, Water Level Probe . . . . .	040002266
11	Screw, #8-32 x .44 Nylon Water Distribution Tube Mounting. . . . .	040001217
12	Screw, #10-24 x .750 Used to Mount Evaporator . . . . .	000005995
13	Screw, #10-24 x .50 . . . . .	000003162
14	Thumbscrew, #8-32 x .44. . . . .	040001217

† Refer to Cross Reference Guide

## ES90 REFRIGERATION COMPARTMENT – COMMON PARTS

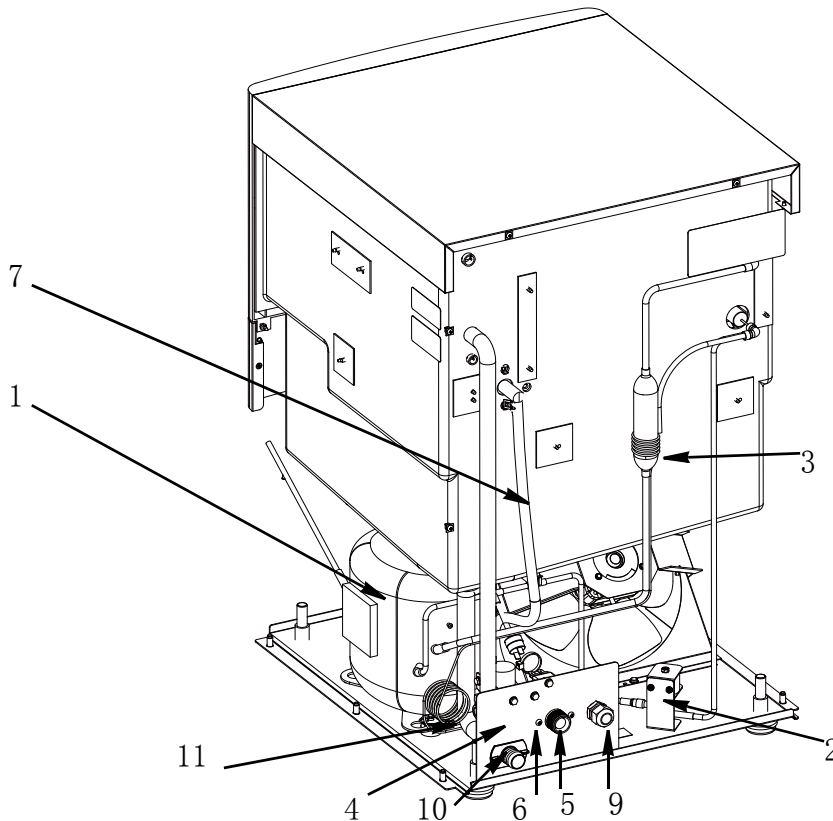

### DESCRIPTION

	<b>PART NO.</b>
<b>1 Compressor Assembly</b>	
a. <b>230V/50 Hz/1 Ph</b> .....	040000175
b. Relay Assembly .....	040000188
c. Overload for Compressor .....	040000190
d. <b>230V/60 Hz/1 Ph</b> .....	040000562
e. Relay Assembly .....	040000597
f. Overload for Compressor .....	040000598
g. Start Capacitor .....	040000599
<b>2 Hot Gas Valve</b>	
a. Hot Gas Valve Including Electrical Coil .....	040000690
<b>3 Restrictor Tube Assembly</b> .....	040003986
<b>Miscellaneous – Brackets, Screws, etc.</b>	
<b>4 Bracket (Water/Electrical Inlet)</b> .....	40001939
<b>5 Water Inlet Valve</b> .....	000001801
<b>6 Screw(Used to Mount Water Inlet Valve)</b> .....	5004421
<b>7 Water Inlet Tubing .375 ID</b> .....	4421113
<b>8 Water Inlet Tubing Spring Clamps-ID 13mm(Not shown)</b> .....	040000773
<b>9 Cord Connector</b> .....	2502283
<b>10 Drain Tubing Fitting-Barbed</b> .....	4011283
<b>11 Drain Tube</b> .....	040002822
<b>12 Drain Tube Clamp(Not shown)</b> .....	5650643
<b>13 Drain Tube Cable Tie #08387(Not shown)</b> .....	5650733
<b>14 Water Dump Valve 220V 50/60Hz (Not shown)</b> .....	040001038
<b>15 Bracket-Dump Valve (Not shown)</b> .....	040002233
<b>16 Screw(Used to Mount Water Dump Valve)</b> .....	5202063

† Refer to Cross Reference Guide

## ES90 REFRIGERATION COMPARTMENT – AIR-COOLED

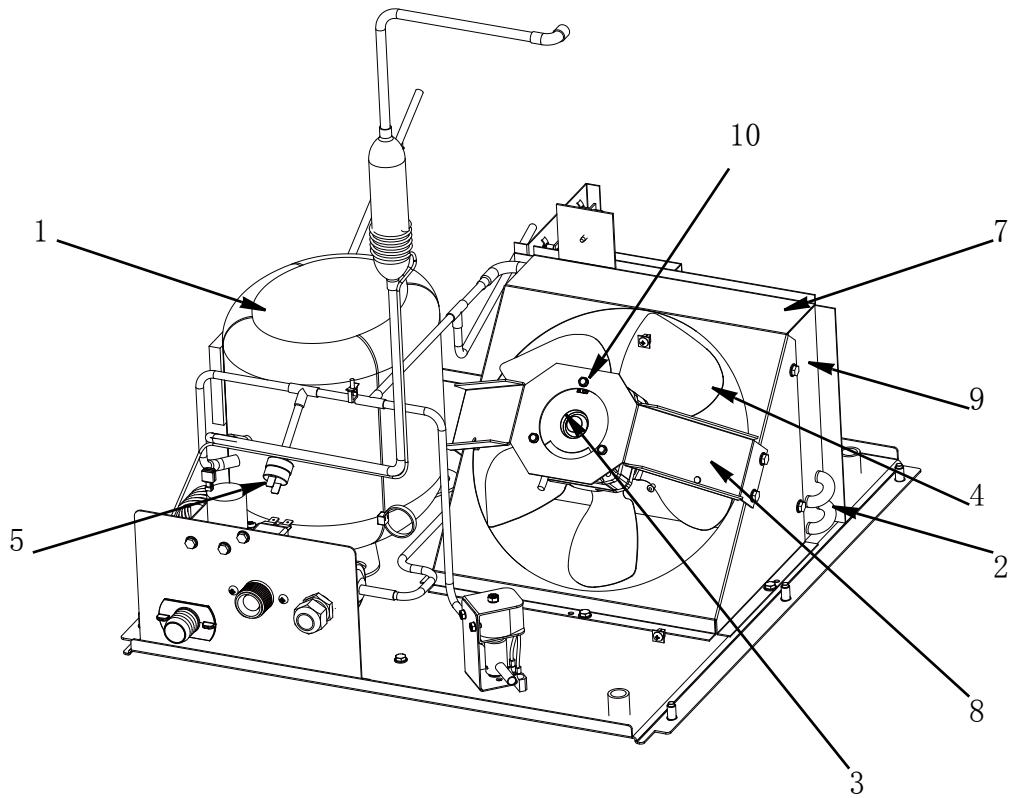

**DESCRIPTION**

**PART NO.**

1	Compressor (Refer to COMMON PARTS Page) . . . . .	Page 4
2	Air Condenser . . . . .	8851353
<b>3</b>	<b>Fan Motor</b>	
	a. 230V/60 Hz . . . . .	2000213
	b. 230V/50 Hz . . . . .	040002962
4	Fan Blade . . . . .	3005653
5	Fan Cycling Control . . . . .	2002293
6	Drier(Not shown) . . . . .	8253433
<b>Miscellaneous – Brackets, Screws, etc.</b>		
7	Fan Shroud . . . . .	6029381
8	Fan Motor Mounting Bracket . . . . .	6061741
9	Screw 10-24X0.5 . . . . .	5202063
10	Screw M4X.7X8MM . . . . .	5005513

† Refer to Cross Reference Guide

## ES90 PANELS

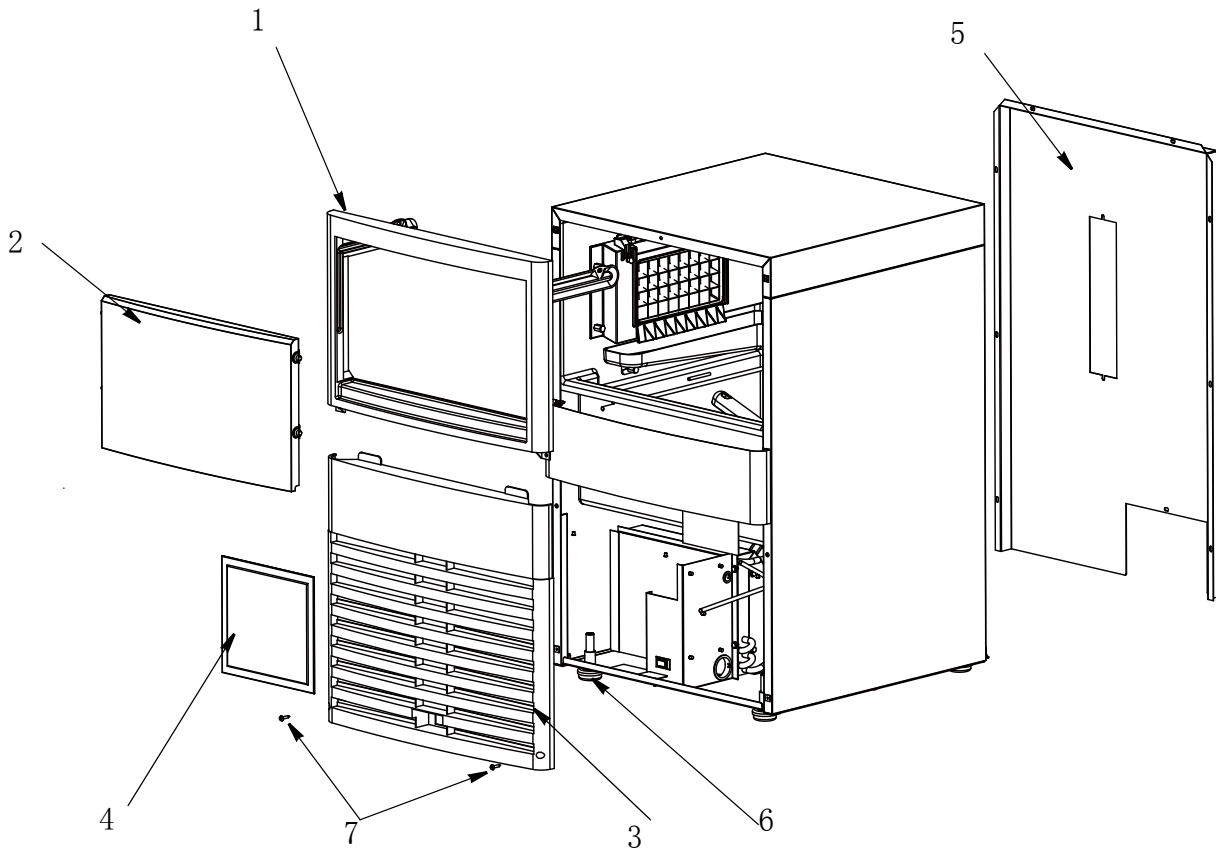

**DESCRIPTION**

	<b>DESCRIPTION</b>	<b>PART NO.</b>
1	Door Frame Assembly . . . . .	040002654
2	Door Assembly . . . . .	040003687
	b. Door Pin Gasket and Door Pin(Not shown) . . . . .	040003698
	c. Door Pin Thumbscrews(Not shown) . . . . .	5012353
3	Front Panel . . . . .	040003689
4	Air Filter . . . . .	040003695
5	Back Panel Assembly . . . . .	040003700
6	Leg Leveler . . . . .	3302613

**Miscellaneous – Brackets, Screws, etc.**

7	Front Panel Screw . . . . .	5202233
8	Ice Scoop (Not shown) . . . . .	4011743